

**Variations:**

L1	L2	12 V	24 V
28	78	531011	531012
53	103	531021	531022
78	128	531031	531032

Current diagram:	12 V	24 V
No load	< 3 A	< 2 A
Normal running	< 7 A	< 4 A
Stall	< 36 A	< 18 A
Fuse	35 A	20 A

**Limited warranty**

- ROCA warrants the wiper motors to be free from defective material and workmanship for a period of 3 years from the date of purchase.
- This warranty does not apply to failure or damage caused by improper installation, misuse, lightning strike or damage from a power surge.
- If failure occurs during this period, return it to your dealer for repair or replacement.

**Wiper arms and blades:**

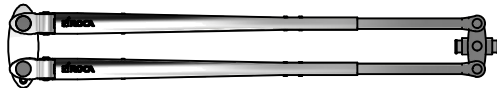

Pantograph  
536330 / 536335 EP  
538330 / 538335 Black



Blade (22"-35")  
520822 - 35

# WIPER MOTOR | W38

## Installation Instructions

Before installation please read these instructions.

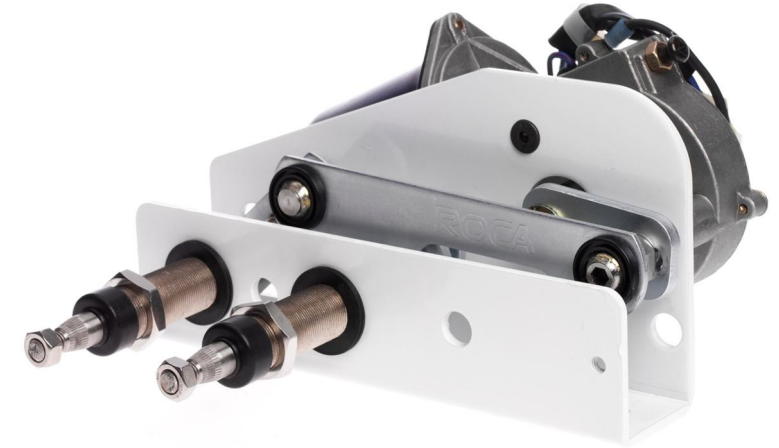

- 2 Speed, self-parking
- Heavy Duty motor, 38Nm
- Wipershaft in stainless steel
- Various sweep angles 45 - 110°
- Dynamic park circuit
- Internal thermo switch
- Insulated ground
- EMC protected
- Powers up to 900 mm/900 mm arm/blade combinations



## Instructions - Adjusting the sweep angle and parking position

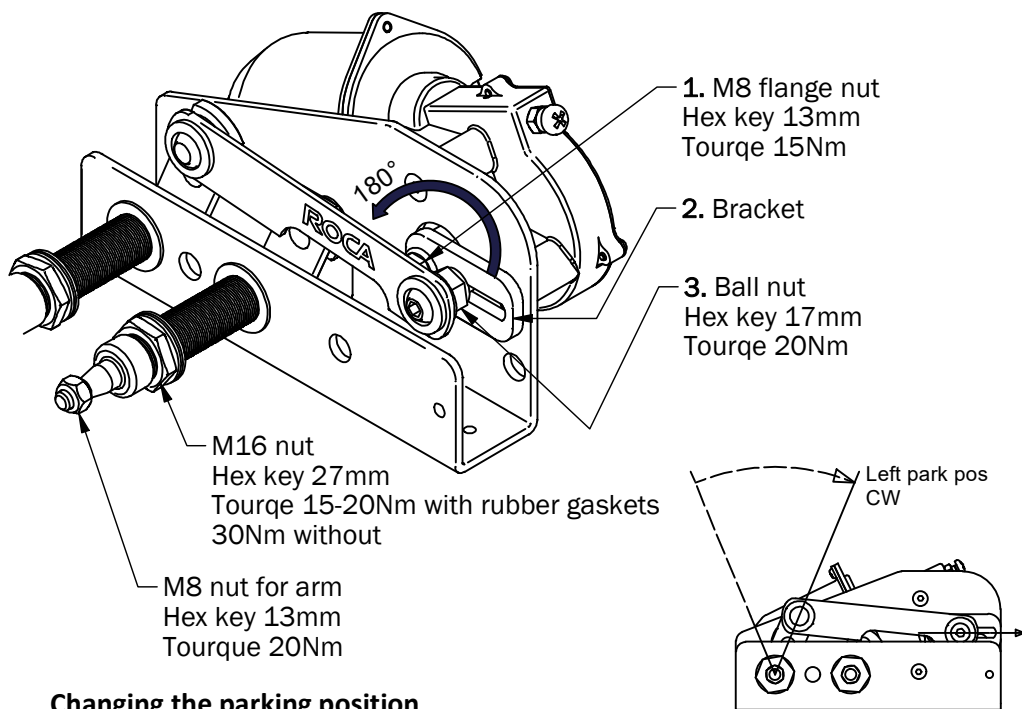

### Changing the parking position

Before the parking position is changed, make sure that the wiper motor is in its parked position (Default is to the left). This is easiest done by turning on and off the power to the wiper motor. For safety, turn off and keep the battery main switch turned off during any operation inside the wiper motor.

- Loosen the nut (1)
- Snap off the bracket from the drive shaft on the motor (2)
- Rotate the bracket 180°
- Assemble the bracket and tighten the nut firmly

### Change of wiper sweep angle

The sweep angle can be set to any value between 45° and 110°. (Default is 45°). Before you change the sweep angle, make sure that the wiper motor is in its parked position. This is done the easiest by turning on and off the power to the wiper motor. For safety, turn off and keep the battery main switch turned off during any operation inside the wiper motor.

- Loosen the nut (3). Note that the nut (3) is left threaded to prevent it from coming loose when running
- Move the nut to desired position in the slot by changing the position of the wiper arm
- Tighten the nut (3) firmly

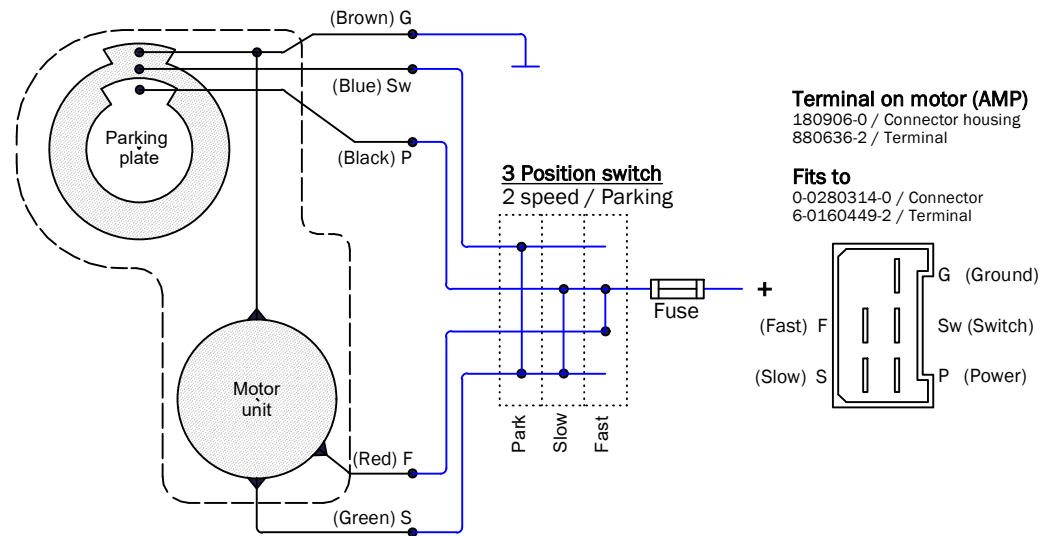

Alt. 1 (3 pos.switch)

Alt. 2 (ROCA switch)

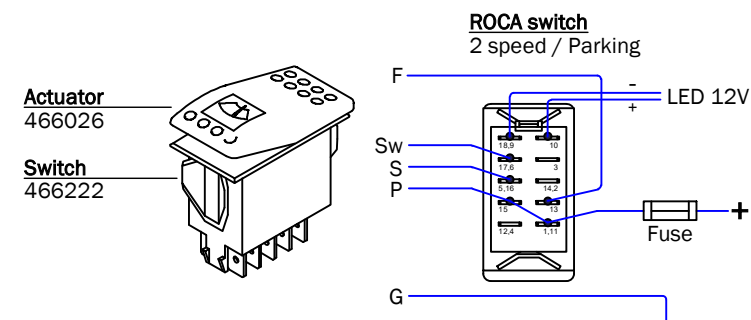

Alt. 3 (On/Off switch)

